

Included in the G980 Airbrick Flood Defence Pack

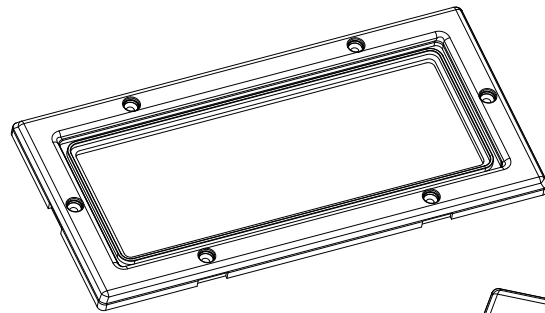

9"x3" Mounting Frame

9"x3" Flood Cover

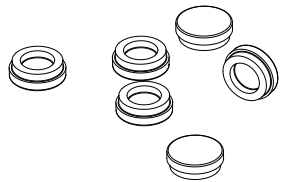
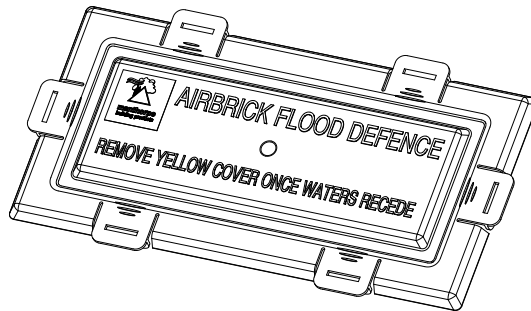

x6 Screw Head Caps

Mounting Frame & Cap Colours:

G980-TR - Terracotta
G980-BR - Brown
G980-GR - Grey

G980-WH - White
G980-BF - Buff
G980-BLB - Blue/Black

The Manthorpe Airbrick Flood Defence can be used in conjunction with The Manthorpe G930 Airbrick and other 9"x3" plastic, clay and concrete airbricks.

Other products from the Manthorpe Range include Cavity Trays, Cavity Closer, Loft Doors, Linear Drainage, Access Panels, Roof Ventilation, Through Wall & Underfloor Ventilation, Joist Seals and Dry Roofing Products.



Manthorpe Building Products Limited

Manthorpe House, Brittain Drive, Codnor Gate Business Park, Ripley, Derbyshire DE5 3ND

T: (01773) 303 000 F: (01773) 303 300 E: mbp.care@manthorpebp.co.uk

W: <http://www.manthorpebp.co.uk>

Manthorpe

Airbrick Flood Defence

Fitting Instructions

MBP_GU_0816_04

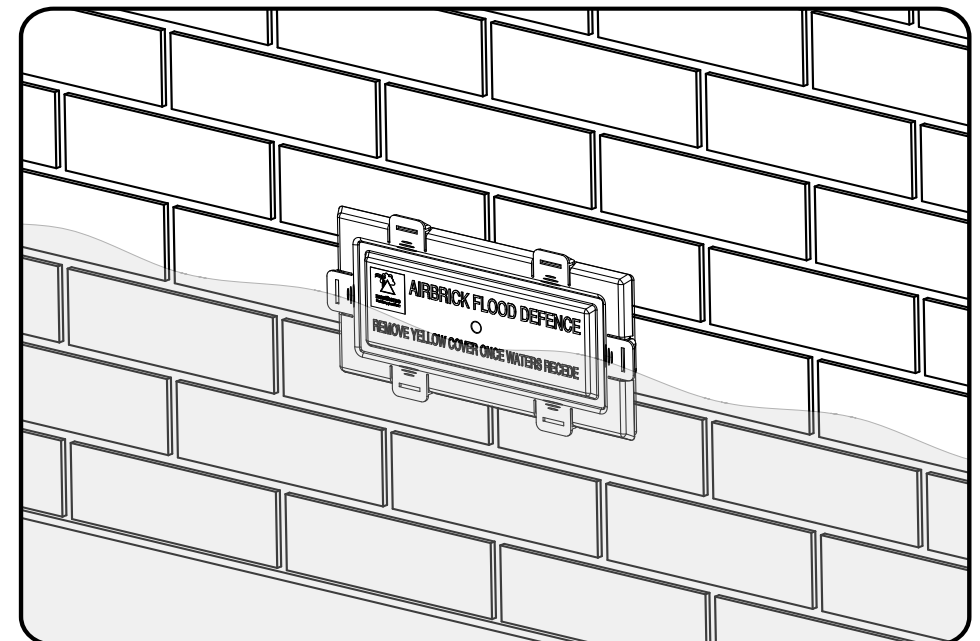

Installation

The Manthorpe Airbrick Flood Defence is designed to cover the opening of a 9"x3" plastic, clay or concrete airbrick, stopping the ingress of water into the property in the event of a flood. Airbricks are one of the first points of entry for rising flood water and a large amount of water could pass through a standard airbrick every hour which would cause substantial damage to any property. With a one off installation of the frame, requiring only simple tools and exterior mastic frame sealant, the property can be protected time and again by clipping on the removable flood covers which are light and easy to store when the flood waters are not threatening.

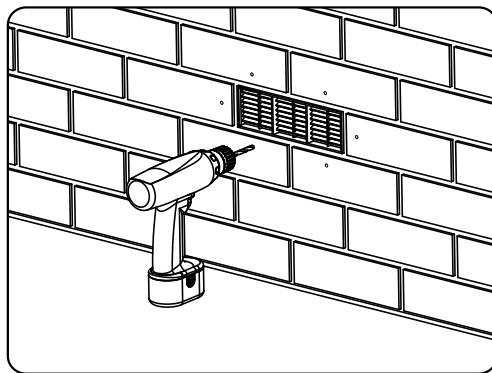

1. Line up the mounting frame over the airbrick and mark the position of the screw holes on the wall. Drill out the screw holes with an appropriate masonry bit and insert wall plugs into the holes.

Remove the screw caps from the edge of the frame and place safely to one side.

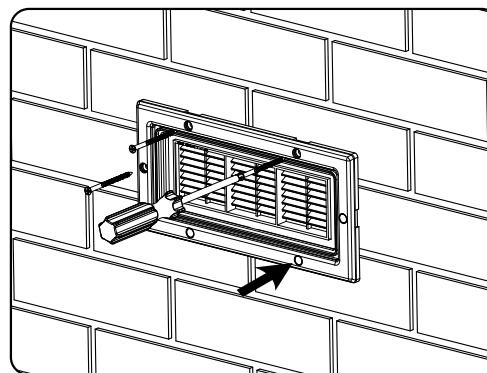

4. Using suitable length 5mm stainless screws, screw the product firmly and evenly to the brickwork. Ensure that the mastic seal around the inside perimeter remains intact. Once the frame is securely fixed in place, press the screw caps into the vacant holes to cover the screw heads and help prevent water ingress and corrosion.

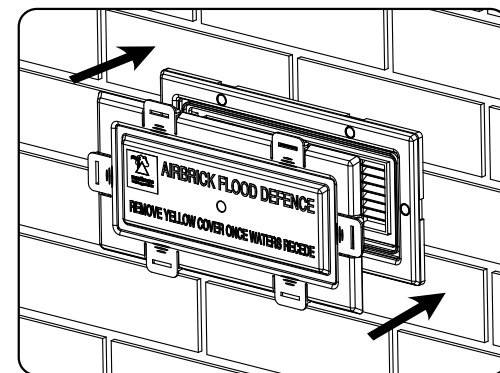

5. Upon a flood warning, take the plastic flood covers and clip them onto each of the mounting frames around the property. This is done by squaring the cover up over the frame and pushing it firmly on ensuring each of the 6 clips locate into their respective grooves.

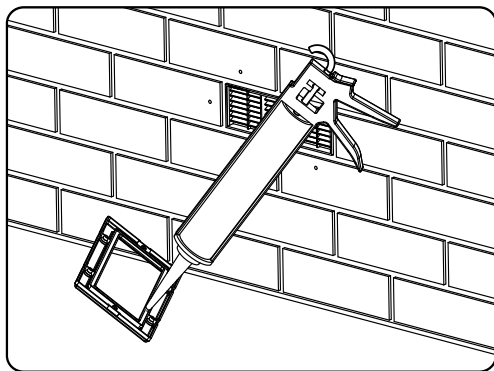

2. Run a thick bead of exterior mastic sealant around the channel on the back of the frame.

Ensuring the product is lined up with the screw holes (using the two end screws at full length as guides is recommended) push the frame onto the wall.

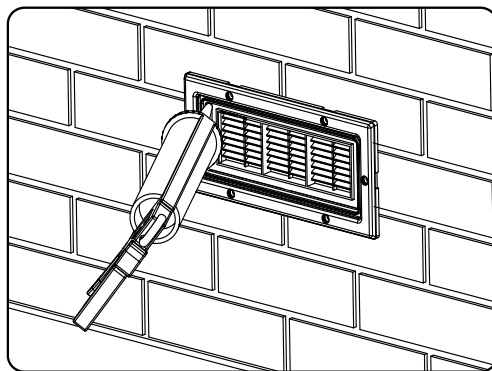

3. To ensure that there is a watertight seal between the frame and the wall, run an additional bead of mastic sealant around the inside perimeter of the frame. This should be manipulated in place to form a constant seal from the internal edge of the frame to the brick/mortar, paying particular attention to the areas where the frame overlaps a mortar course.

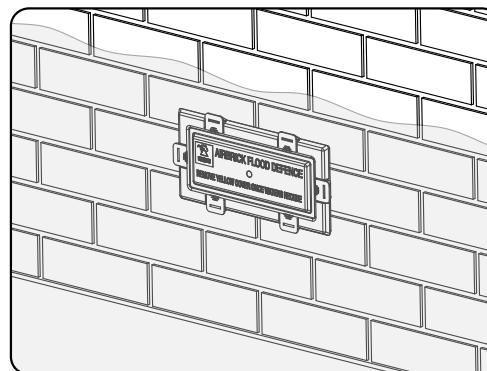

6. Do not remove any of the covers while the flood waters are high, this will lead to a rapid torrent of water entering the property, causing substantial damage.

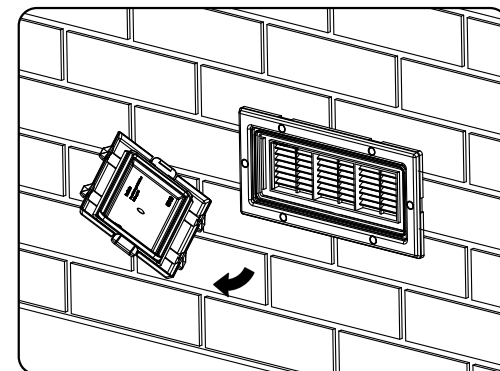

7. Once the waters do subside and the threat of any additional flood warnings have passed, be sure to remove the covers from the airbricks, and any other flood protection equipment from the property. This is strongly advised by the Environment Agency as it will help the property to dry out.

NB. The National Flood Forum advises that where there is a risk of flooding to a depth of more than a metre, then keeping the water out can sometimes do more harm than good. The pressure of water against the property may cause structural damage to the building itself. The manufacturer does not guarantee that the product alone will prevent floodwater damage, as water can penetrate numerous openings around a property. This product however will significantly delay the ingress of water, allowing much needed time to safeguard valuables.