

## The Complete System

*The G900 5" Core Drill Vent Kit comprises:*

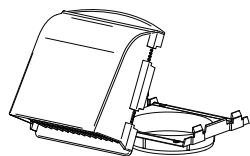

Full Hood Vent Cowl  
inc. standard backplate

Brown, Terracotta, White

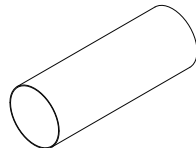

5" (127mm) Pipe Duct  
350mm long

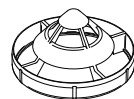

Anti-Draught  
Baffle

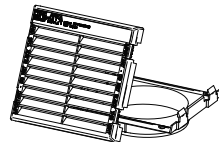

Louvre Vent Grille  
inc. standard backplate

White

Other products from the Manthorpe Range include Cavity Trays, Cavity Closer, Loft Doors, Linear Drainage, Access Panels, Roof Ventilation, Through Wall & Underfloor Ventilation, Joist Seals and Dry Roofing Products.



### Manthorpe Building Products Limited

Manthorpe House, Brittain Drive, Codnor Gate Business Park, Ripley, Derbyshire DE5 3ND

T: (01773) 303 000 F: (01773) 303 300 E: [mbp.care@manthorpebp.co.uk](mailto:mbp.care@manthorpebp.co.uk)

W: <http://www.manthorpebp.co.uk>

# Manthorpe

## 5" Core Drill Ventilator

### Fitting Guide

MBP\_GU\_8260\_11

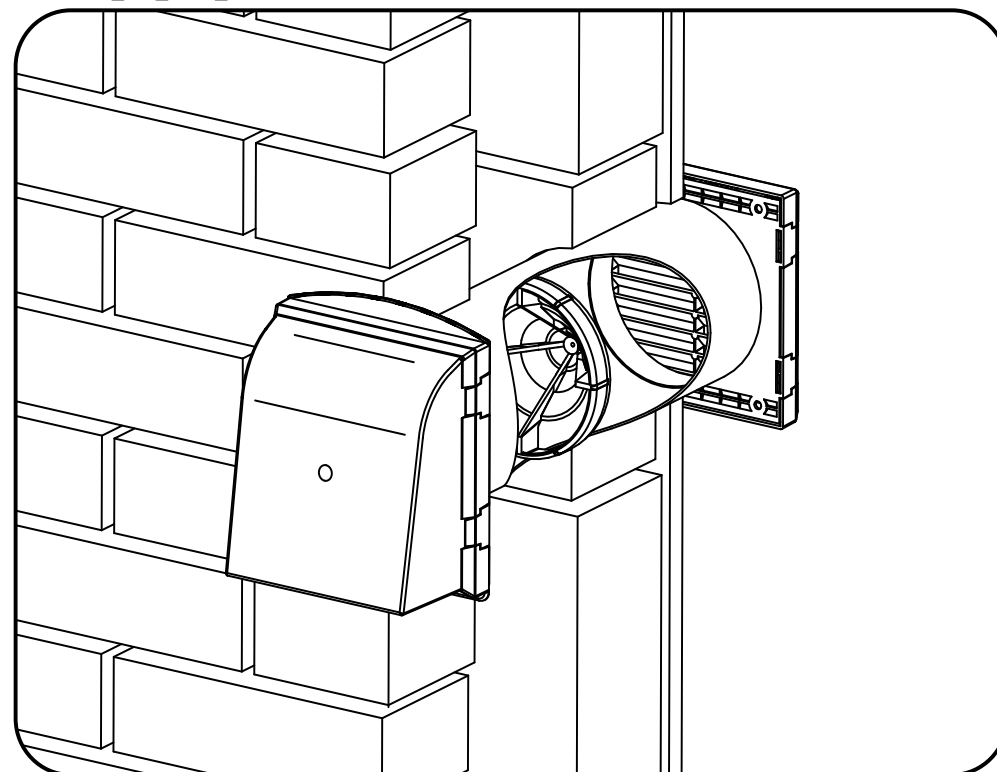

## Installation

The Manthorpe 5" Core Drill Vent kit is designed specifically for providing ventilation to gas appliances, although they can be used as general ventilation as well. Due to the nature in which the products are fitted, they are ideal for refurbishment and new build situations. The G900 standard kit includes an optional anti-draught baffle which reduces the amount of noticeable draught through the vent. **With** the anti-draught baffle in place, the effective free area of the system is **70cm<sup>2</sup>**, enough to ventilate a gas appliance with a maximum input rating of **21kW (71,500 Btu/h)**. **Without** the use of the baffle, the free area increases to **100cm<sup>2</sup>**, enough to ventilate a gas appliance with a maximum input rating of **27kW (92,000 Btu/h)**. (Input rating figures calculated in accordance with BS5440 pt.2-2000)

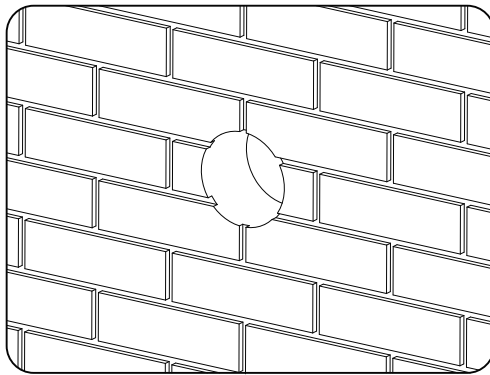

**1.** Using a 5" (127mm) diameter core drill and a suitable power drill, cut a hole through the entire thickness of the wall. Always consult the core drill manufacturers instructions before using the drill.

The kits can accommodate an overall wall thickness of 350mm, for wider details a longer 5" diameter pipe will need to be sourced (not available from Manthorpe).

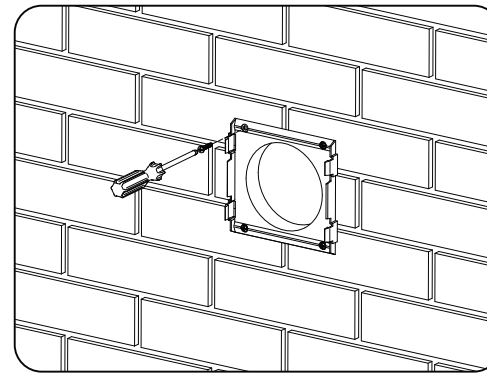

**4.** Remove the cowl and louvre grilles from their backplates by releasing the clips on either side. Using suitable length 4mm screws and corresponding wall plugs, securely fasten the coloured backplate to the outside face of the wall. Ensure that the spigot from the backplate is pushed fully inside the duct. Repeat this step on the inside of the property with the white backplate.

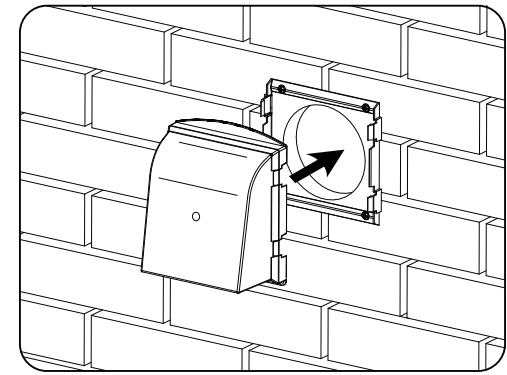

**5.** On the exterior of the building, simply push fit the cowl vent onto the already secured backplate ensuring that the clips down each side engage securely.

Ensure that the grille of the cowl is facing downward to allow the hood to effectively protect the opening from the elements.

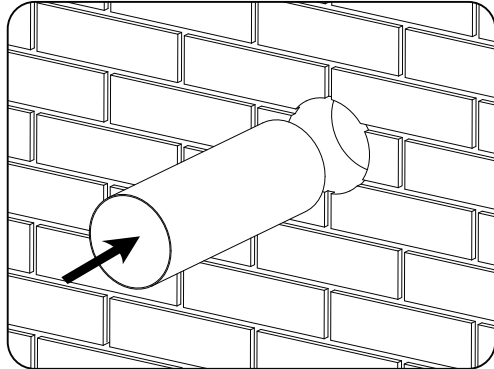

**2.** Feed the pipe duct through the newly cut hole until the end sits flush with the surface of the wall at one side.

Mark and trim the other end of the pipe to finish flush at the other side, if necessary. Seal the gaps in the wall penetration around the pipe with a suitable exterior grade mastic.

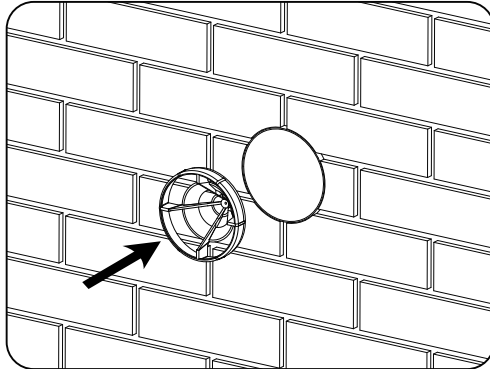

**3.** If using the anti-draught baffle to reduce the effective free vent area of the 5" pipe, it will need to be installed at this stage.

Simply push the baffle inside the pipe duct with the point of the cone facing inside the building. Position the baffle approximately halfway along the length of the duct ensuring it remains vertical.

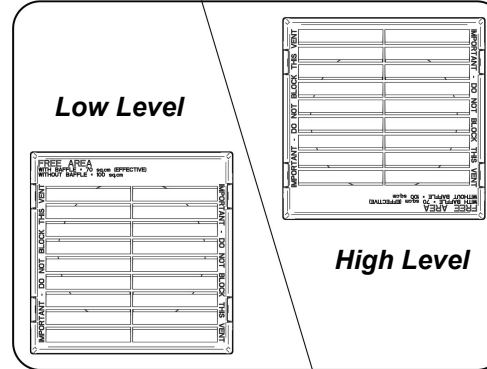

**6.** Repeat step 5 on the inside of the property using the white louvre grille. Orient the louvre as shown in the diagram above, depending on whether the vent is positioned towards the floor or ceiling.

By orientating the vent in these ways, the amount of visible light and noticeable draught through the vent will be reduced.

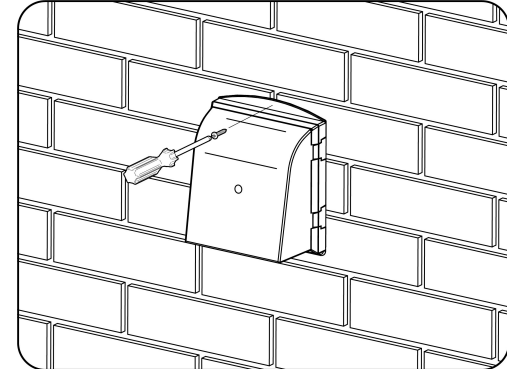

**7.** For additional security, the exterior cowl vent can be screwed to the wall. Drill out the two holes blacks with a 6mm drill bit using the guides on the underside of the cowl. Using suitable length 5mm screws and wall plugs, fasten the cowl to the exterior wall.