

Telescopic Underfloor Void Ventilator

Code: **G960**

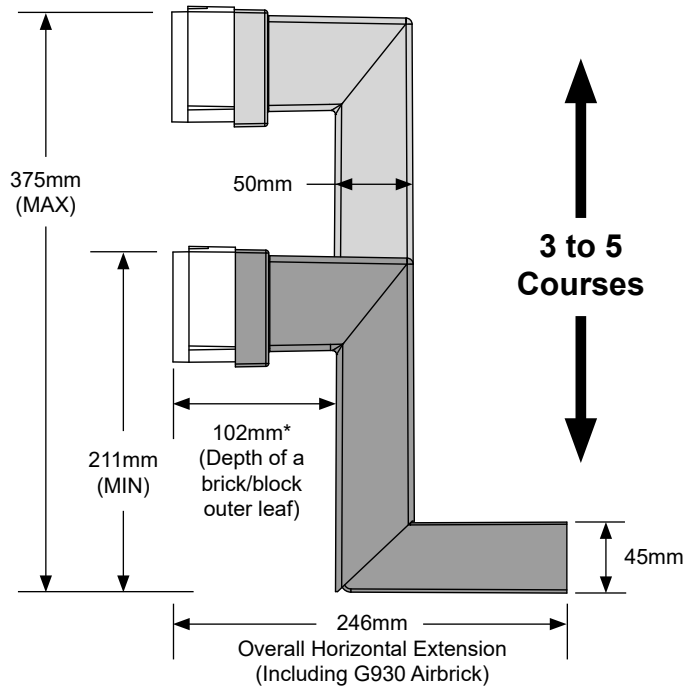
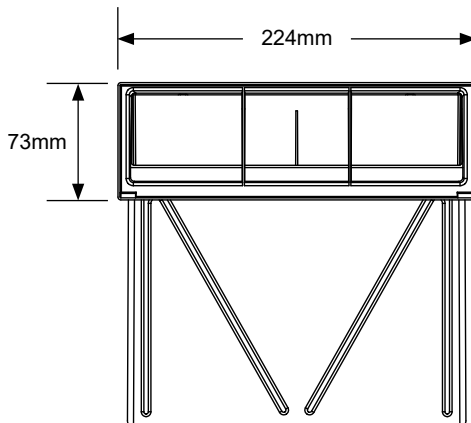
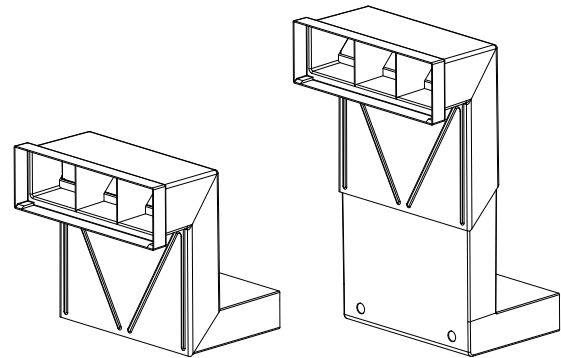
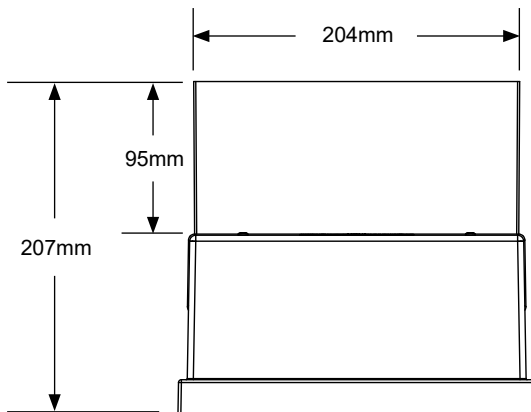

*G930 Airbrick sold separately

Description

The G960 telescopic underfloor void ventilator is designed to provide a clear airflow passage to the void beneath a suspended floor.

The telescopic design enables the G960 to adjust vertically between 3 and 5 brick courses. The G961 extension sleeve is also available for adding an extra 150mm adjustment vertically or horizontally per unit for larger details.

The front aperture is able to take a G930 Airbrick or a traditional 9"x3" clay/cast iron airbrick albeit with a reduced airflow.

Colour	Black
Packing Details	20 per box
Part Weight	0.39kg
Box Weight	8.4kg
Material	Polypropylene
Manufacturing Process	Injection Moulded
Free Area	6,450mm ² When using G930 Airbrick* (8,000mm ² G960 only)

MANTHORPE BUILDING PRODUCTS LTD
MANTHORPE HOUSE
BRITAIN DRIVE
CODNOR GATE BUSINESS PARK
RIPLEY
DERBYSHIRE DE5 3ND

TEL: 01773 303 000
FAX: 01773 303 300
EMAIL: mbp.care@manthorpebp.co.uk
WEB: www.manthorpebp.co.uk

DRAWN	ISSUE DRAWN
B.H. 12/06/23	B.H. 12/06/23

The company maintains a policy of continuous development of its product range and reserves the right to amend the specification without notice.

DRG No

MBP 8382

Issue

01
1 of 2

Telescopic Underfloor Void Ventilator

Code: **G960**

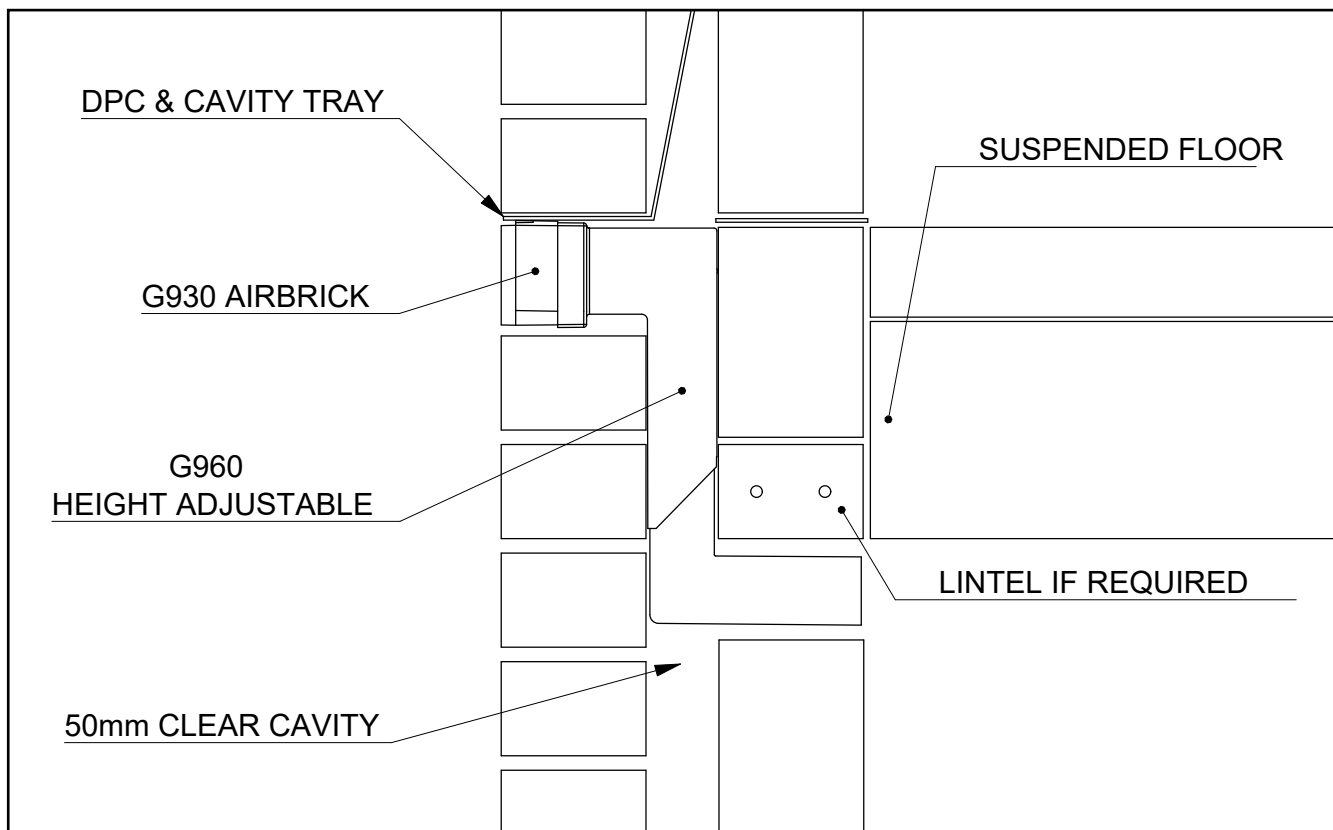

Fitting Instructions

The G960 consists of a upper section which slots over a lower section, allowing it to be telescopically adjustable. A G930 airbrick should be pushed into the front upper aperture. The G960 can be adjusted vertically by moving the upper section up and down as needed. Ensure both sections are slotted together once installed. If fitted above the D.P.C a suitable cavity tray should be fitted above the G960.

As per BS 5250:2021 - 10.5.6, 'subfloor ventilation should be provided by evenly spaced vents having a free area of not less than 1,500mm²/m run of external wall or 500 mm²/m² of floor area, whichever is the greater. Vents should be placed on at least two opposing elevations at no more than 2m centres and no more than 450mm from the corner of the building'

For further reference, please see Building Regulations Approved Document C - 4.19 (2013), NHBC 5.2.10 and BS 5250:2021 for additional guidance.

Bricklaying should then be completed as normal although care should be taken to keep the air flow passage clear from mortar droppings.

This product should be used in conjunction with other products from the Manthorpe 'Through Wall & Underfloor' range to provide a complete ventilation system.

Please note this is not a structural load bearing product. Drawings are illustrative only.

MANTHORPE BUILDING PRODUCTS LTD
MANTHORPE HOUSE
BRITTAIN DRIVE
CODNOR GATE BUSINESS PARK
RIPLEY
DERBYSHIRE DE5 3ND

TEL: 01773 303 000
FAX: 01773 303 300
EMAIL:
mbp.care@manthorpebp.co.uk
WEB:
www.manthorpebp.co.uk

DRAWN	ISSUE DRAWN
B.H. 12/06/23	B.H. 12/06/23

The company maintains a policy of continuous development of its product range and reserves the right to amend the specification without notice.

DRG No

MBP 8382

Issue

01
1 of 2