

## Ridge Details

### Detailed view of ridge assembly using the Saddle Clamp system

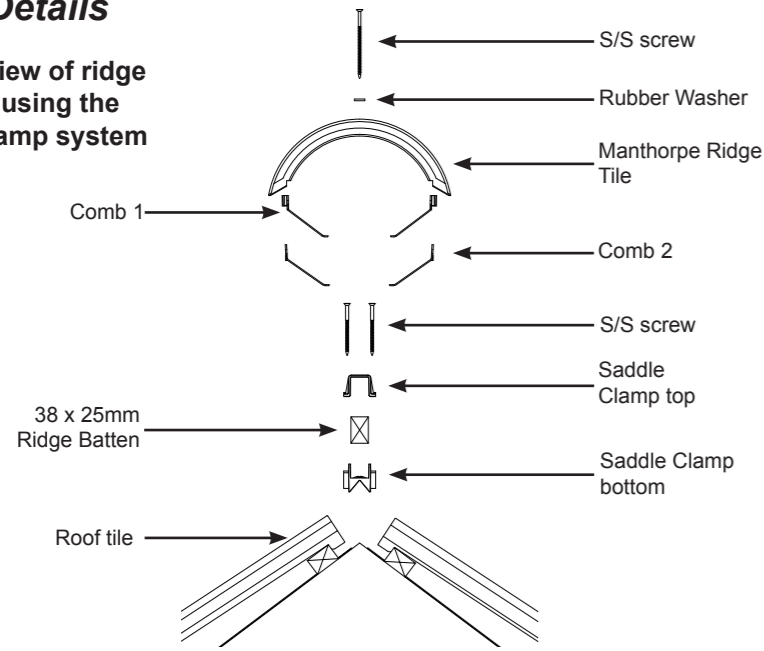

### Detailed view of ridge assembly using the Batten Support Bracket system

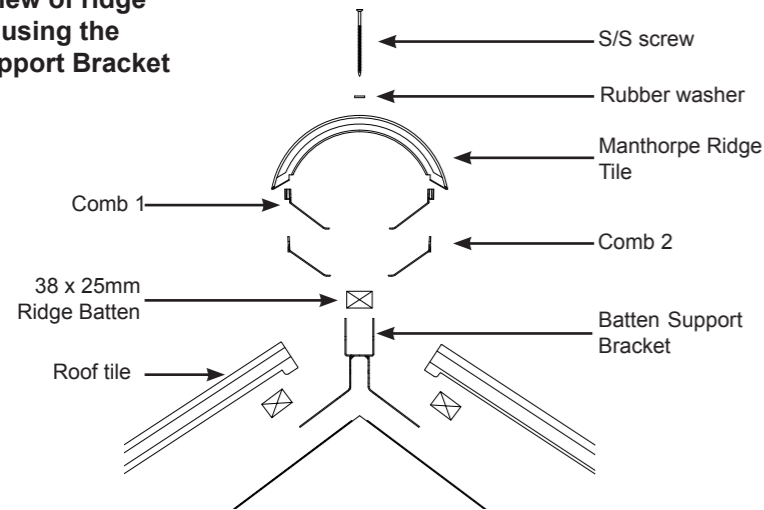

**NOTE:** This product should not be installed within close proximity to potentially hot elements of the roof structure, such as chimney pots or flue outlets, or on a roof surface which could reach excessively high temperatures, such as metal clad or glazed roofs.

## The Complete System

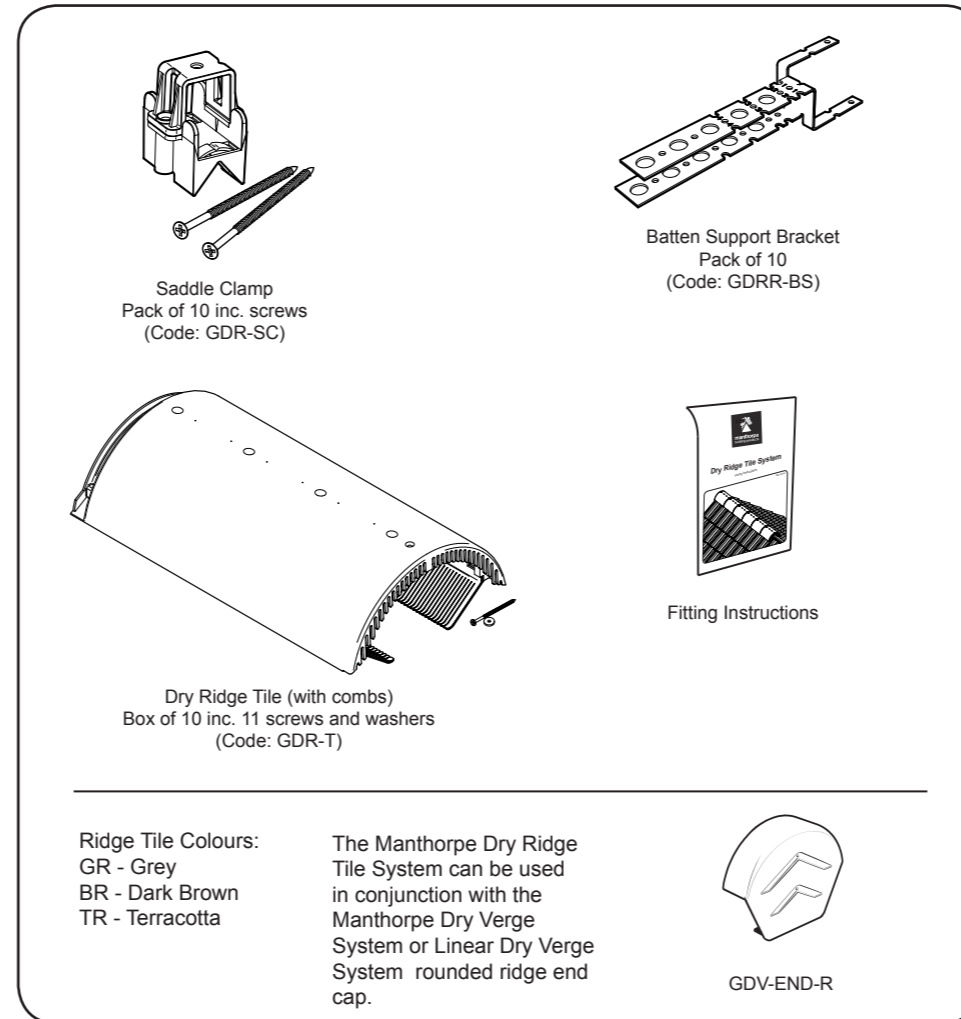

Other products from Manthorpe include Cavity Trays, Cavity Closer, Loft Doors, Linear Drainage, Access Panels, Roof Ventilation, Through Wall & Underfloor Ventilation, Joist Seals and Dry Roofing Products.



### Manthorpe Building Products Limited

Manthorpe House, Brittain Drive, Codnor Gate Business Park, Ripley, Derbyshire DE5 3ND  
 T: (01773) 303 000 F: (01773) 303 300 E: mbp.care@manthorpebp.co.uk  
 W: <http://www.manthorpebp.co.uk>

# Manthorpe

## Dry Ridge Tile System

Fixing Instructions

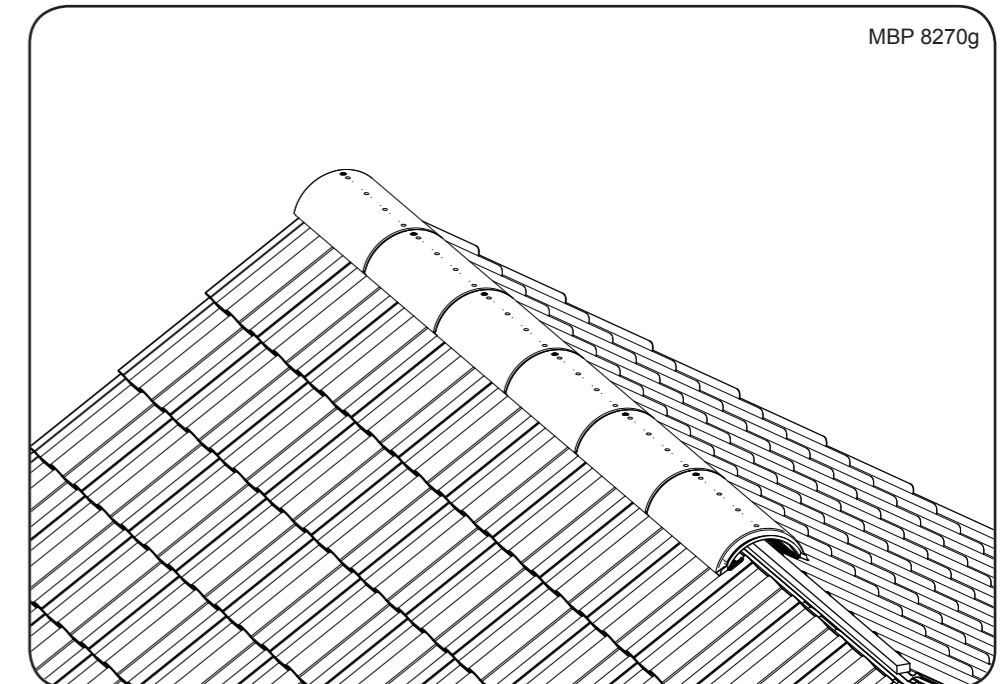

## Installation using the Saddle Clamp - Refurbishment Situation

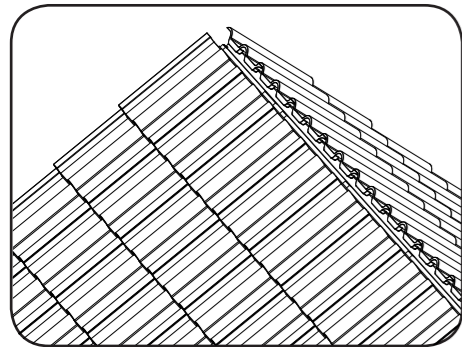

**1.** Strip the ridge tiles and old mortar to expose the felt. If ventilation is required and a gap doesn't already exist, the felt must be carefully cut to obtain a 5mm wide gap along the full length of the ridge.

For non ventilated ridges, check the felt and dress the underlay over the apex if necessary.

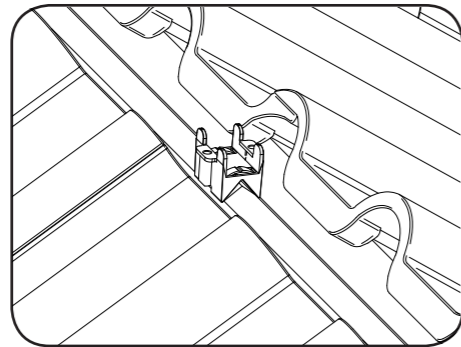

**2.** (If the roof is built in the traditional method, where a ridge board already exists, there is no need to install a ridge batten, so continue to step 5)

Locate the apex of each of the rafters and place a Saddle Clamp base at the top of each rafter along the ridge.

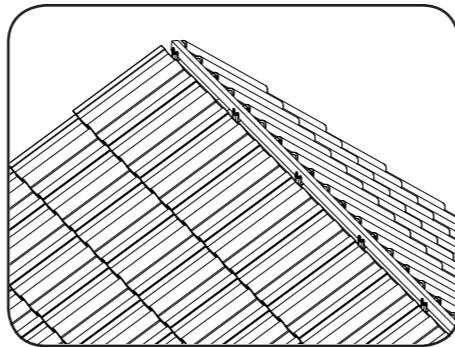

**3.** Lay a length of 38mm x 25mm timber batten between the Saddle Clamps, ensuring it sits in the recess of each clamp.

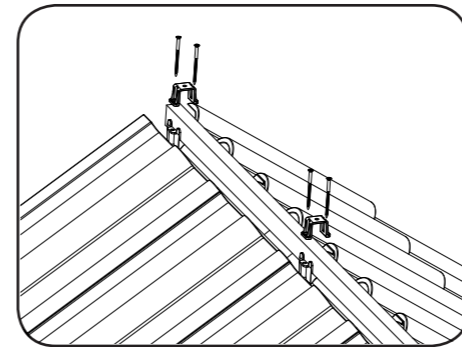

**4.** Place the top half of the Saddle Clamp over the batten and line up the holes with the base. Using the screws provided, securely fasten the entire assembly down, ensuring the screws penetrate the trusses substantially.  
N.B. If additional batten height is required, a second batten can be secured along the top of the first batten.  
(CONTINUE TO STEP 5)

## Final Installation Steps - Both Systems

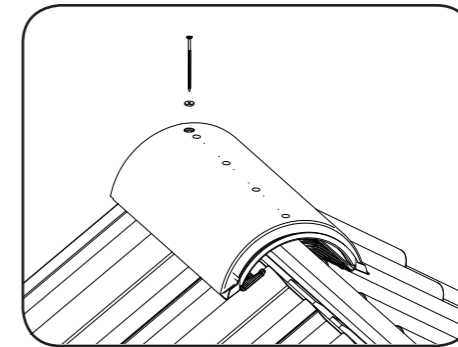

**5.** Position the first Plastic Ridge Tile flush with the end of the ridge batten and secure through the lone counterbored screw hole using one of the supplied screws and rubber washers. Ensure that the screw substantially penetrates the ridge batten below and that the comb fingers shape themselves to the profile of the roof covering, providing protection from wind driven rain.

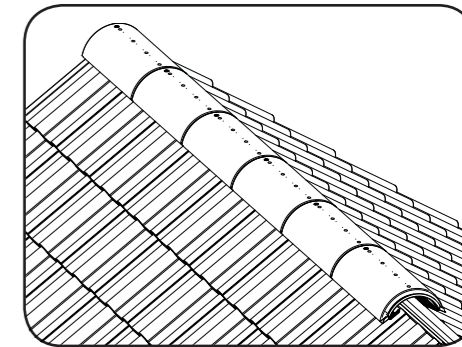

**6.** Repeat this process along the ridge until all the ridge tiles have been laid ensuring each tile interlocks correctly with the previous one.

If mortar is not being used at the ends of the ridge, a Manthorpe Ridge End Cap should be used.

## Installation using the Batten Support Bracket - New Build Situation

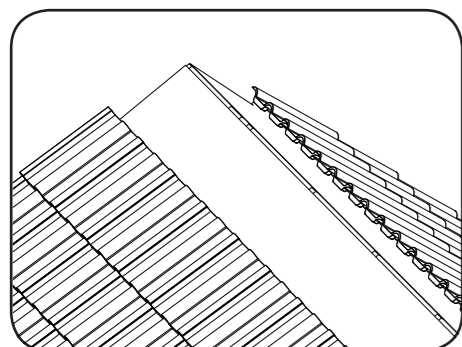

**1.** Lay the roof underlay as normal. If ventilation is required through the ridge, the underlay should be left short of the apex to provide a 5mm air gap.

For non-ventilated details, dress the underlay over the apex as normal.

Batten the roof as normal, up to, but excluding the top course tiling battens.

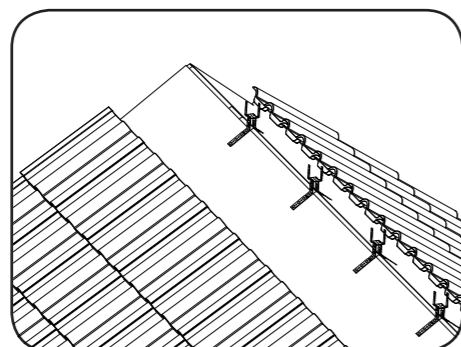

**2.** Adjust the height of the Batten Support Brackets to suit the tile profile and roof pitch, by bending at one of the 4 marked positions.

Using 30mm stainless steel annular ring shanked nails, fix a Batten Support Bracket to the apex of every rafter. Nail each bracket to the rafters through two holes on each side.

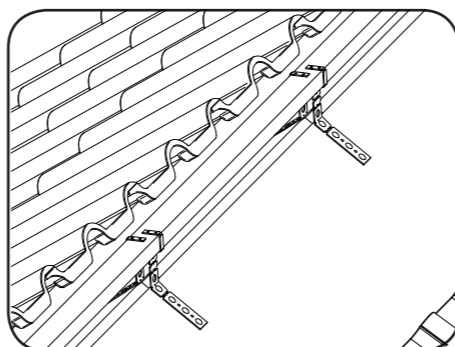

**3.** Lay a length of 38mm x 25mm timber batten between the Support Brackets, then bend the two up-stands over the batten and nail in place.

If a Manthorpe Dry Verge system is being used, ensure that the ridge batten overhangs the verge by 30mm at each end.

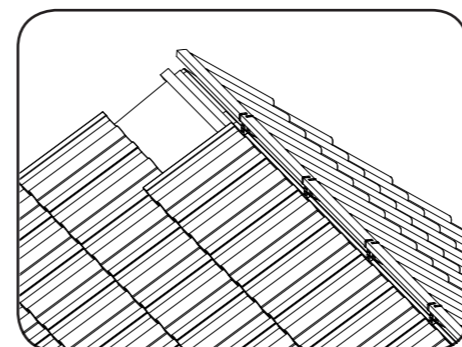

**4.** Replace the top batten and top row of tiles as per the manufacturer's recommendations and usual good roofing practice.

(CONTINUE TO STEP 5)

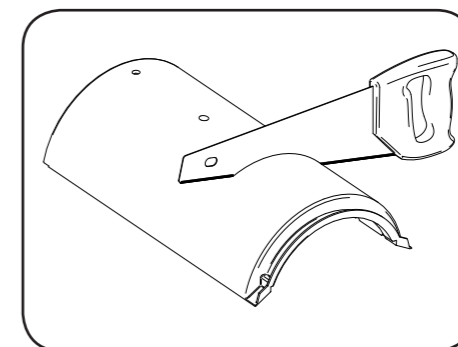

**7.** Manthorpe Plastic Ridge Tiles can easily be sawn to length to make fit at the end of a ridge run, a chimney abutment or similar.

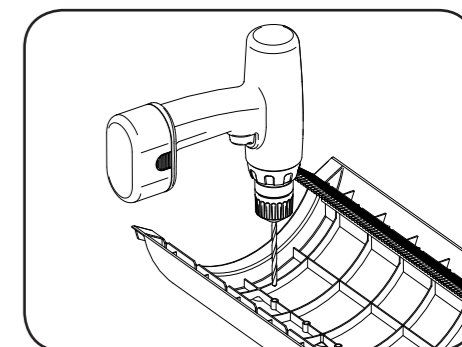

**8.** Along the length of the tile are additional blanked off screw bosses located on the underside. To secure the loose end of the final tile along a run, turn the product upside down and use a 5mm drill bit to drill out the screw boss nearest to the unsecured end. Place in position and secure using the extra screw and rubber washer provided.